

- ★ - Tie Sheet Is Available
- △ - Designates S.L. County Surveyor's File No.
- - Designates S.L. County Recorder's File No.

| REVISIONS | | | |
|-----------|----------|---|---------|
| NO. | DATE | DESCRIPTION OF REVISION | INITIAL |
| 1 | 9-28-93 | Update 1992 Subdivisions | LJP |
| 2 | 2-06-95 | Rubber Sheeted | SW |
| 3 | 6-20-96 | Jordan Pines Townhomes | P.J.L |
| 4 | 6-20-96 | Changed S.L.Co. Surveyor-Vaughn E. Butler | P.J.L |
| 5 | 8-5-96 | The Woods @ Creekview Ph. 2 | P.J.L |
| 6 | 11-07-96 | Pat Turner's Place Sub. | LJP |
| 7 | 11-9-98 | The Woods @ Creekview Phase 3A Sub. | PPM |
| 8 | 11-12-98 | Southwest Industrial Center | PPM |
| 9 | 12-30-99 | Southwest Industrial Center Am'd & Ext'd | PSB |
| 10 | 6-6-00 | Naylor Farm Subdivision | PSB |
| 11 | 8-9-00 | The Woods @ Creekview Phase 3A-1 Sub. Am'd | PSB |
| 12 | 7-14-03 | Heritage Park Estates Plat A | PSB |
| 13 | 9-30-03 | Naylor Farm Subdivision Am'd | PSB |
| 14 | 2-24-04 | Heritage Park Estates Plat B | PSB |
| 15 | 5-3-04 | The Woods @ Creekview Phase 3B Sub. | PSB |
| 16 | 11-24-04 | Heritage Park Estates Plat C | PSB |
| 17 | 3-14-06 | The Village at Naylor Farm Subdivision Am'd | PSB |
| 18 | 8-11-08 | Changed S.L.Co. Surveyor-Reid J. Demman | MSK |

SEC. 05
T3S-R1W

AREA REFERENCE PLAT

PREPARED BY THE OFFICE OF
THE SALT LAKE COUNTY SURVEYOR

COMPILED BY
REID J. DEMMAN
SALT LAKE COUNTY SURVEYOR

NOTICE
THE VALUES SHOWN HEREON REFERENCE THIS PLAT ONLY. ADJACENT AREA REFERENCE PLATS MAY SHOW DIFFERENT VALUES FOR IDENTICAL LINES. A.R.P. VALUES HAVE BEEN GATHERED OVER A NUMBER OF YEARS, USING A VARIETY OF EQUIPMENT WITH VARYING DEGREES OF ACCURACY. ALL INFORMATION SHOWN IS FOR REFERENCE ONLY AND SHOULD BE FIELD VERIFIED. COPIES OF FIELD TRAVERSES ARE AVAILABLE FOR MOST SECTIONS. STATE PLANE COORDINATES ARE ALSO AVAILABLE FOR SOME SECTIONS. PLEASE CHECK WITH STAFF.

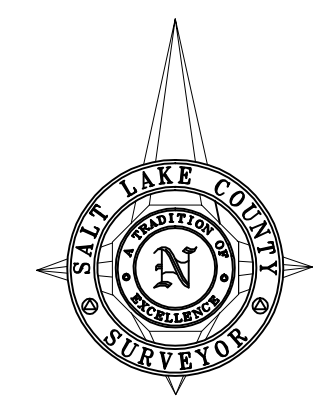

SCALE 1" = 300'

Date Converted - 08/06/92

SALT LAKE COUNTY
GEOGRAPHIC INFORMATION SYSTEM
©1992

05-T3S-R1W

05-T3S-R1W