

★ -Tie Sheet Is Available  
 Δ -Designates S.L. County Surveyor's File No.  
 ▭ -Designates S.L. County Recorder's File No.

NOTICE

THE VALUES SHOWN HEREON REFERENCE THIS PLAT ONLY. ADJACENT AREA REFERENCE PLATS MAY SHOW DIFFERENT VALUES FOR IDENTICAL LINES. A.R.P. VALUES HAVE BEEN GATHERED OVER A NUMBER OF YEARS, USING A VARIETY OF EQUIPMENT WITH VARIOUS DEGREES OF ACCURACY. ALL INFORMATION SHOWN IS FOR REFERENCE ONLY AND SHOULD BE FIELD VERIFIED. COPIES OF FIELD TRAVERSES ARE AVAILABLE FOR MOST SECTIONS. STATE PLANE COORDINATES ARE ALSO AVAILABLE FOR SOME SECTIONS. PLEASE CHECK WITH STAFF.

REVISIONS			
NO.	DATE	DESCRIPTION OF REVISION	INITIAL
1	2-09-95	Rubber Sheeted	SW
2	8-18-99	Change S.L. Co. Surveyor-Vaughn E. Butler	PSB
3	8-18-99	Standardize Layer Colors	PSB
4	8-18-99	Oquirrh Park Subdivision Phase 1	PSB
5	10-18-99	Oquirrh Park Subdivision Phase 2	PSB
6	8-29-01	Oquirrh Park Subdivision Phase 2-4	PSB
7	8-30-01	Oquirrh Park Subdivision Phase 2-5	PSB
8	9-4-01	Oquirrh Park Subdivision Phase 2-6	PSB
9	9-5-01	Oquirrh Park Subdivision Phase 2-7	PSB
10	9-6-01	Oquirrh Park Subdivision Phase 2-8	PSB
11	11-19-01	Oquirrh Park Subdivision Phase 2-11	PSB
12	11-20-01	Oquirrh Park Subdivision Phase 2-12 thru 2-15	PSB
13	11-21-01	Oquirrh Park Subdivision Phase 2-16	PSB
14	12-10-01	Oquirrh Park Subdivision Phase 2-9	PSB
15	12-10-01	Oquirrh Park Subdivision Phase 2-10	PSB
16	11-27-02	Oquirrh Park Subdivision Phase 3A-Plat A	PSB
17	11-27-02	Kennecott Master Subdivision #1	PSB
18	10-20-03	Oquirrh Park Subdivision Phase 3A-Plat B	PSB
19	12-11-03	Kennecott Master Subdivision #1 Amended	PSB
20	4-4-06	Oquirrh Park Subdivision Phase 3A-Plat C	PSB
21	8-11-08	Change S.L. Co. Surveyor-Reid J. Demman	MSK

SEC. 18  
 T3S-R1W  
**AREA REFERENCE PLAT**

PREPARED BY THE OFFICE OF  
THE SALT LAKE COUNTY SURVEYOR

COMPILED BY  
**REID J. DEMMAN**  
 SALT LAKE COUNTY SURVEYOR

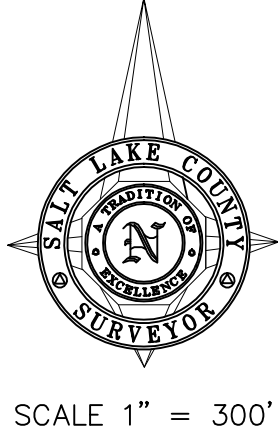

SCALE 1" = 300'

Date Converted - 08/14/92

SALT LAKE COUNTY  
GEOGRAPHIC INFORMATION SYSTEM  
©1992