

- ★ -Tie Sheet Is Available
- △ -Designates S.L. County Surveyor's File No.
- -Designates S.L. County Recorder's File No.

NOTICE

THE VALUES SHOWN HEREON REFERENCE THIS PLAT ONLY. ADJACENT AREA REFERENCE PLATS MAY SHOW DIFFERENT VALUES FOR IDENTICAL LINES. A.R.P. VALUES HAVE BEEN GATHERED OVER A NUMBER OF YEARS, USING A VARIETY OF EQUIPMENT WITH VARYING DEGREES OF ACCURACY. ALL INFORMATION SHOWN IS FOR REFERENCE ONLY AND SHOULD BE FIELD VERIFIED. COPIES OF FIELD TRAVERSES ARE AVAILABLE FOR MOST SECTIONS. STATE PLANE COORDINATES ARE ALSO AVAILABLE FOR SOME SECTIONS. PLEASE CHECK WITH STAFF.

REVISIONS			
NO.	DATE	DESCRIPTION OF REVISION	INITIAL
1	11-7-97	ARP Generated from Work Sheet	PSB
2	11-7-97	Standardize Layer Colors	PSB
3	11-10-97	Cone Subdivision	PSB
4	11-10-97	Crosby Subdivision	PSB
5	11-10-97	Greiff Estates	PSB
6	11-10-97	John Patrick Dehaan Subdivision	PSB
7	11-10-97	Kelsch Subdivision	PSB
8	11-10-97	Wallis Subdivision	PSB
9	11-10-97	Woodhead Subdivision	PSB
10	11-10-97	Woodhead Subdivision Am'd	PSB
11	11-10-97	"WL" Subdivision	PSB
12	11-10-97	Ashley Subdivision	PSB
13	11-10-97	Nathan's Land Subdivision	PSB
14	11-10-97	Harmony Woods Subdivision	PSB
15	11-10-97	Chris Oneida Subdivision	PSB
16	11-21-97	Ohlweiler Subdivision #2	PSB
17	2-2-98	Shaggy Mountain Ranch Subdivision	PSB
18	3-27-98	Thomas E. Dehaan Subdivision	MDS
19	4-15-98	Hi-Country Estates Subdivision	PSB
20	7-15-98	Elaine Meadows Subdivision	MDS
21	9-14-00	Kurt Barlow Subdivision	PSB
22	1-24-01	Foster-Woodhead Subdivision	PSB
23	5-11-01	Thomas E. Dehaan Subdivision Amended	PSB
24	12-19-01	Alta Mist Alpacas	PSB
25	12-20-01	Kurt Barlow Subdivision No. 2	PSB
26	7-30-02	Hansen Place Subdivision	PSB
27	10-7-02	Culver Subdivision	PSB
28	5-20-02	Robinson Estates	PSB
29	1-13-04	Cascade Estates	PSB
30	4-01-04	Thomas E. Dehaan Subdivision Phase 2	PSB
31	9-21-04	Scenic Mountain Subdivision	PSB
32	9-23-04	Elaine Meadows #2	PSB
33	11-10-05	Shaggy Mountain Estates Subdivision	PSB
34	8-11-08	Changed S.L.Co. Surveyor - Reid J. Demman	MSK

SEC. 4 T4S-R2W AREA REFERENCE PLAT

PREPARED BY THE OFFICE OF
THE SALT LAKE COUNTY SURVEYOR

COMPILED BY
REID J. DEMMAN
SALT LAKE COUNTY SURVEYOR

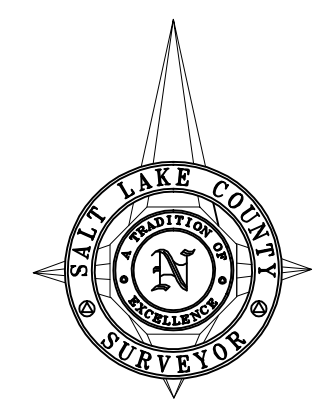

SCALE 1" = 300'