

- REFERENCES:
1. THAYNE'S ATLAS P.20
 2. OWNERSHIP PLATS
 3. JOB NO 162

ORIGIN OF COORDINATES IS THE SAME AS IS USED IN THE CITY PLUS SYSTEM
 COORDINATES WRITTEN ABOVE AND TO THE RIGHT OF THE INTENDED POINT UNLESS OTHERWISE INDICATED

- ★ -Tie Sheet Is Available
- ▭ -Designates S.L. County Surveyor's File No.
- ▭ -Designates S.L. County Recorder's File No.

BLOCKS 07,08 10 - ACRE PLAT "A" AREA REFERENCE PLAT

NOTICE

THE VALUES SHOWN HEREON REFERENCE THIS PLAT ONLY. ADJACENT AREA REFERENCE PLATS MAY SHOW DIFFERENT VALUES FOR IDENTICAL LINES. A.R.P. VALUES HAVE BEEN GATHERED OVER A NUMBER OF YEARS, USING A VARIETY OF EQUIPMENT WITH VARIOUS DEGREES OF ACCURACY. ALL INFORMATION SHOWN IS FOR REFERENCE ONLY AND SHOULD BE FIELD VERIFIED. COPIES OF FIELD TRAVERSES ARE AVAILABLE FOR MOST SECTIONS. STATE PLANE COORDINATES ARE ALSO AVAILABLE FOR SOME SECTIONS. PLEASE CHECK WITH STAFF.

REVISIONS			
NO.	DATE	DESCRIPTION OF REVISION	INITIAL
1	6-20-96	Wood Point Condominiums	P.J.L.
2	6-20-96	Changed S.L.Co. Surveyor-Vaughn E. Butler	P.J.L.
3	10-22-96	300 East St. & Gordon Lane Dedication	L.J.P.
4	5-13-99	Willow Grove Condominiums	PSB
5	1-04-01	Aspen Meadows Condominiums	PSB
6	6-12-01	Oak Park Condominiums Phase 1	PSB
7	10-18-01	Oak Park Condominiums Phase 2	PSB
8	12-18-01	Oak Park Condominiums Phase 3	PSB
9	11-15-07	Changed S.L.Co. Surveyor-Reid J. Demman	MSK

PREPARED BY THE OFFICE OF
 THE SALT LAKE COUNTY SURVEYOR

REID J. DEMMAN
 SALT LAKE COUNTY SURVEYOR

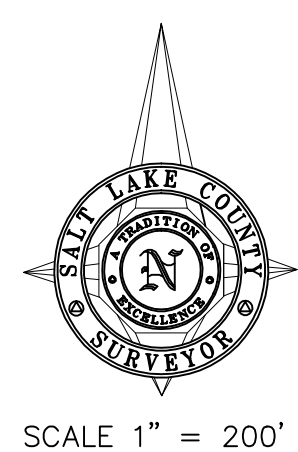

SCALE 1" = 200'