

Precinct NRV020

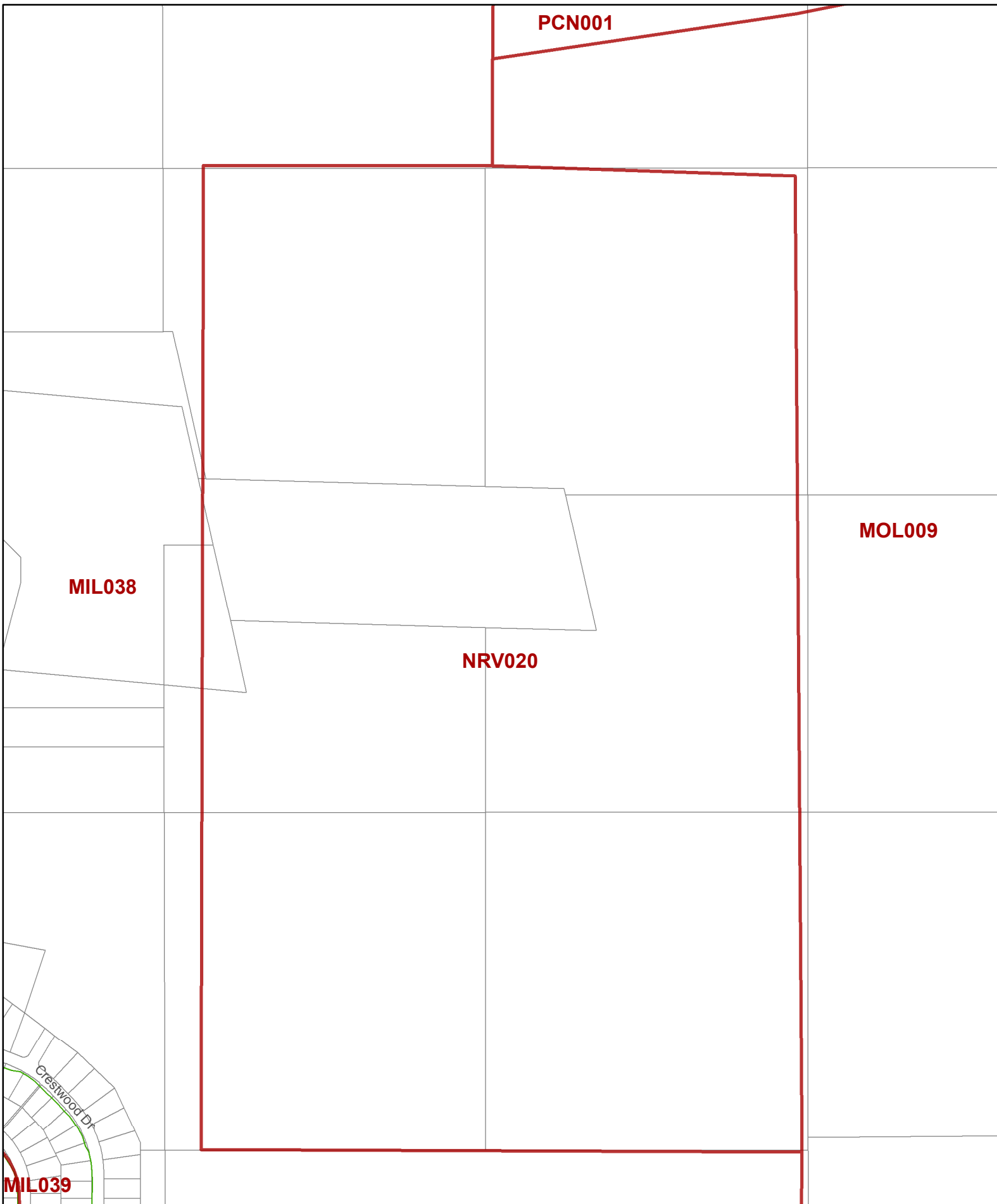

From the office of:
SHERRE SWENSON
Salt Lake County Clerk
2001 S State St, Rm 51 200
Salt Lake City, UT 84110
(385) 468-8683

Legend

Streets 2017_Voting Precincts Parcels

In conjunction with the offices of:
Salt Lake County Assessor
Salt Lake County Recorder
Salt Lake County Surveyor



Map Date: May, 2017