

ORIGIN OF COORDINATES IS THE SAME AS IS USED IN THE CITY PLUS SYSTEM. COORDINATES WRITTEN ABOVE AND TO THE RIGHT OF THE INTENDED POINT UNLESS OTHERWISE NOTED.

NOTE: UNABLE TO PLOT THE FOLLOWING ON THIS A.R.P.
 Sub of Lots 20 & 21 RIVERSIDE PLAT D-32
 Bargar Annex 78-1-30

- ★ - Tie Sheet is Available
- △ - Designates S.L. County Surveyor's File No.
- - Designates S.L. County Recorder's File No.

NOTICE

THE VALUES SHOWN HEREON REFERENCE THIS PLAT ONLY. ADJACENT AREA REFERENCE PLATS MAY SHOW DIFFERENT VALUES FOR IDENTICAL LINES. A.R.P. VALUES HAVE BEEN GATHERED OVER A NUMBER OF YEARS, USING A VARIETY OF EQUIPMENT WITH VARYING DEGREES OF ACCURACY. ALL INFORMATION SHOWN IS FOR REFERENCE ONLY AND SHOULD BE FIELD VERIFIED. COPIES OF FIELD TRAVERSES ARE AVAILABLE FOR MOST SECTIONS. STATE PLANE COORDINATES ARE ALSO AVAILABLE FOR SOME SECTIONS. PLEASE CHECK WITH STAFF.

REVISIONS			
NO.	DATE	DESCRIPTION OF REVISION	INITIAL
1	12-19-94	Minor Sub.	LJP
2	3-30-95	Rubber Sheeted	SW
3	5-1-95	Cannon Farms Sub. No. 2	LJP
4	5-1-95	Added Notice	LJP
5	10-16-96	Cannon Farms Amended Sub. No. 2	BJB
6	10-16-96	Change S.L. Co. Surveyor - Vaughn E. Bullter	BJB
7	7-29-97	Lincoln Village Am'd	PSB
8	12-6-00	McKeage's First Subdivision Amended	PSB
9	8-7-01	Cannon Place Subdivision	PSB
10	8-23-02	Margaret Street Business Park	PSB
11	7-18-03	Cannon Farms Sub. No. 3	PSB
12	10-25-05	Cannon Farms Sub. No. 4	PSB
13	8-11-08	Change S.L. Co. Surveyor - Reid J. Demman	MSK

SEC. 14 T1S-R1W AREA REFERENCE PLAT

PREPARED BY THE OFFICE OF
THE SALT LAKE COUNTY SURVEYOR

COMPILED BY
REID J. DEMMAN
SALT LAKE COUNTY SURVEYOR

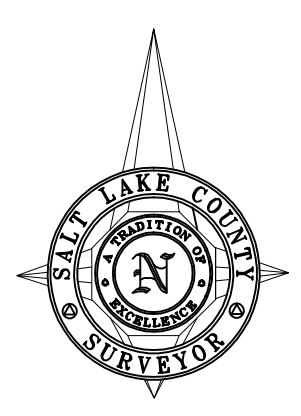

SCALE 1" = 300'

Date Converted - 05/28/92

SALT LAKE COUNTY
GEOGRAPHIC INFORMATION SYSTEM
©1992

14-T1S-R1W

14-T1S-R1W