

NOTICE

THE VALUES SHOWN HEREON REFERENCE THIS PLAT ONLY. ADJACENT AREA REFERENCE PLATS MAY SHOW DIFFERENT VALUES FOR IDENTICAL LINES. A.R.P. VALUES HAVE BEEN GATHERED OVER A NUMBER OF YEARS, USING A VARIETY OF EQUIPMENT WITH VARYING DEGREES OF ACCURACY. ALL INFORMATION SHOWN IS FOR REFERENCE ONLY AND SHOULD BE FIELD VERIFIED. COPIES OF FIELD TRAVERSES ARE AVAILABLE FOR MOST SECTIONS. STATE PLANE COORDINATES ARE ALSO AVAILABLE FOR SOME SECTIONS. PLEASE CHECK WITH STAFF.

SEC. 29 T1S-R2W AREA REFERENCE PLAT

- ★ - Tie Sheet Is Available
- △ - Designates S.L. County Surveyor's File No.
- - Designates S.L. County Recorder's File No.

PREPARED BY THE OFFICE OF
THE SALT LAKE COUNTY SURVEYOR

REID J. DEMMAN
SALT LAKE COUNTY SURVEYOR

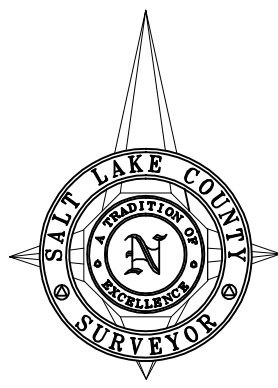

SCALE 1" = 300'

REVISIONS			
NO.	DATE	DESCRIPTION OF REVISION	INITIAL
18	9-28-93	Update 1992 Sign Specifications	BJS
19	12-28-94	Copper Mountain Subdiv. Am'd Phase V	BJS
20	13-28-95	Copper Creek Condominiums Am'd Phase VI	BJS
21	6-30-96	Walden Estates Am'd & Ext'd	BJS
22	8-26-95	Copper Mountain Subdiv. No. 2	BJS
23	9-26-95	9900 Condos Subdiv. Amended	BJS
24	6-10-96	Walden Estates Subdiv. Am'd	BJS
25	6-29-97	Chrispen Seveler Estate of J. Demman	MJK
9	6-26-96	Changes Surveyor to Vaughn E. Butler	LJP
10	7-30-96	Copper Creek Condominiums	PJL
11	11-5-96	Walton Estates	BJS
12	12-11-96	Copper Creek Condos Amended - Phase 1	BJS
13	3-10-97	Copper Creek Condos Amended - Phase 2	BJS
14	6-20-97	Pleasant Green Condos	BJS
15	7-28-97	Oquirrh Canyon Sub.	PSB
16	10-2-97	Copper Creek Condos Amended - Phase 3	PSB
17	2-11-98	Copper Creek Condos Amended - Phase 4	MDS

Date Converted - 06/26/92

SALT LAKE COUNTY
GEOGRAPHIC INFORMATION SYSTEM
©1992