

INTERSECTION  
DETAIL

INTERMOUNTAIN  
SUBDIVISION

REFERENCES:  
FIELD BOOK 60 & 121  
WORKSHEET NO.2

NO.	DATE	REVISIONS	DESCRIPTION OF REVISION	INITIAL
1	9-22-83	Update 1993 Subdivisions		LJP
2	11-24-94	Carriage Lane No. 2 Sub.		LJP
3	1-1-94	Carriage Creek Sub. Plat 1		LJP
4	7-18-94	Bradford Sub. Amended		LJP
5	18-4-94	The Madras Condos		LJP
6	7-4-94	Carriage Lane No. 2 Sub. Amended		LJP
7	10-29-94	Subdiv. Amended		LJP
8	4-28-95	Stoneybrook P.U.D.		LJP
9	4-28-95	Alpine Gardens		LJP
10	12-15-95	Change County Surveyor, Vaughn E. Butler		ALM
11	12-15-95	Stoneybrook Lower Colors		ALM
12	1-10-96	Council Plaza Subdivision		ALM
13	2-02-96	Amended Stoneybrook P.U.D.		ALM
14	04-09-96	Amended Madras Condos		B-B
15	10-2-96	Source Hill Sub.		B-B
16	18-19-97	Vine Street Townhome P.U.D.		B-B
17	2-03-98	Stoneybrook Subdivision Phase 2		PSB
18	5-22-98	Vine Street Office Park Condo's Phase 1		MUS
19	4-06-98	Miracle Mine Subdivision Am'd		PSB
20	8-18-98	Miracle Mine Subdivision		PSB
21	11-14-98	Madras Mine Subdivision		PSB
22	2-27-99	Ethal Bradford Subdivision		PSB
23	19-28-99	Chimney Ridge Subdivision		PSB
24	12-16-99	Show Estates Subdivision		PSB
25	11-01-00	Etha Historic Subdivision		PSB
26	2-20-01	Clearbrook Condominiums		PSB
27	8-9-01	Stoneybrook Subdivision		PSB
28	10-19-01	Matthew Johnson Subdivision		PSB
29	7-10-01	Miracle Mine Subdivision Am'd		PSB
30	10-10-03	Etha Historic Renovation Condo Am'd		PSB
31	4-8-03	Intermountain Subdivision		PSB
32	7-30-03	Source Hill Subdivision		PSB
33	11-19-07	Change County Surveyor, Reid J. Demman		MSK

**SOUTH HALF SEC 06 & SEC. 07 T2S-R1E AREA REFERENCE PLAT**  
 PREPARED BY THE OFFICE OF THE SALT LAKE COUNTY SURVEYOR  
**REID J. DEMMAN**  
 SALT LAKE COUNTY SURVEYOR  
 SALT LAKE COUNTY  
 GEOGRAPHIC INFORMATION SYSTEM  
 \*1992

**NOTICE**  
 THE VALUES SHOWN REFERENCE THIS PLAT ONLY. ADJACENT AREA REFERENCE PLATS MAY SHOW DIFFERENT VALUES FOR IDENTICAL LINES. A.R.P. VALUES HAVE BEEN GATHERED OVER A NUMBER OF YEARS, USING A VARIETY OF EQUIPMENT WITH VARYING DEGREES OF ACCURACY. ALL INFORMATION SHOWN IS FOR REFERENCE ONLY AND SHOULD BE FIELD VERIFIED. COPIES OF FIELD TRAVERSES ARE AVAILABLE FOR MOST SECTIONS.  
 STATE PLANE COORDINATES ARE ALSO AVAILABLE FOR SOME SECTIONS. PLEASE CHECK WITH STAFF.

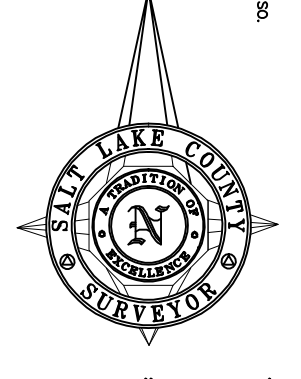

SCALE 1" = 300'