

- ★ - Tie Sheet is Available
- △ - Designates S.L. County Surveyor's File No.
- - Designates S.L. County Recorder's File No.

SEC. 10 T2S-R1E

AREA REFERENCE PLAT

PREPARED BY THE OFFICE OF
THE SALT LAKE COUNTY SURVEYOR

REID J. DEMMAN
SALT LAKE COUNTY SURVEYOR

NOTICE

THE VALUES SHOWN HEREON REFERENCE THIS PLAT ONLY. ADJACENT AREA REFERENCE PLATS MAY SHOW DIFFERENT VALUES FOR IDENTICAL LINES. A.R.P. VALUES HAVE BEEN GATHERED OVER A NUMBER OF YEARS, USING A VARIETY OF EQUIPMENT WITH VARYING DEGREES OF ACCURACY. ALL INFORMATION SHOWN IS FOR REFERENCE ONLY AND SHOULD BE FIELD VERIFIED. COPIES OF FIELD TRAVERSES ARE AVAILABLE FOR MOST SECTIONS. STATE PLANE COORDINATES ARE ALSO AVAILABLE FOR SOME SECTIONS. PLEASE CHECK WITH START.

REVISIONS			
NO.	DATE	DESCRIPTION OF REVISION	INITIAL
1	11-4-93	Shelly Sub.	LJP
2	3-10-95	Rubber Sheeted	SW
3	12-20-95	Added Notice	ALM
4	12-20-95	Change S.L. County Surveyor, Vaughn E. Butler	ALM
5	12-20-95	Standardize Layer Colors	ALM
6	12-20-95	Haven Cove Amended Sub.	ALM
7	4-12-96	Cottonwood Cove Condos, Phase 1	BJB
8	4-12-96	Cottonwood Cove Condos, Phase 2	BJB
9	6-10-96	Walker Estates Townhomes	LJP
10	6-20-96	Cottonwood Cove Condos, Phase 3	LJP
11	7-10-96	The Highlands	PJL
12	7-15-96	The Vail Subdivision	LJP
11	7-10-96	Cottonwood Cove Condos, of Holladay Ph. 4	PJL
12	10-3-96	Normandy Lane Sub.	BJB
13	6-10-97	Woods of Arbor	BJB
14	10-8-97	Grant Harrison Sub.	PSB
15	11-25-97	Corrected bearing and dist. on Holladay Blvd.	LJP
16	5-19-98	Holladay Boulevard Ests. Condos' Ph. 1 & 2	MDS
17	10-6-98	Seastrand Subdivision	PPM
18	12-23-98	Cottonwood Cove Condos' of Holladay Ph. V	PSB
19	7-13-99	Haven Cove Subdivision #2 Am'n	PSB
20	9-13-99	Clarendon Woods Subdivision	PSB
21	6-5-01	Holladay Park Woods	PSB
22	4-18-03	Holladay Boulevard Ests. Condos' Ph. 3	PSB
23	12-23-03	Highland Rose Lane Condominiums	PSB
24	1-21-04	Grant Harrison Sub. #2	PSB
25	11-19-07	Change S.L. County Surveyor, Reid J. Demman	MSK

- REFERENCES:
- FIELD BOOK 21 & 53
 - WORK SHEET 10 & 11
 - FIELD BOOK 16 & 27
 - 65 & 69
 - 5 & 30

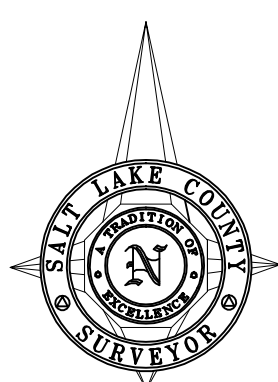

- CORRECTIONS:
1. TIE TO 1011
 2. TIE TO 413 8 MUR.-HOLL. RD.
 3. DIST. ON VALLEY VIEW AVE.
 4. N. LINE NE 4 RECALCULATED
 5. E. LINE SEC. RECALCULATED

SCALE 1" = 300'

Date Converted - 09/24/92

SALT LAKE COUNTY
GEOGRAPHIC INFORMATION SYSTEM
©1992