

- ★ - Tie Sheet Is Available
- △ - Designates S.L. County Surveyor's File No.
- - Designates S.L. County Recorder's File No.

REVISIONS			
NO.	DATE	DESCRIPTION OF REVISION	INITIAL
1	9-9-93	Update 1992-93 Subdivisions	LJP
2	11-3-93	Sanders Sub.	LJP
3	1-06-94	Beals Sub.	LJP
4	2-02-94	Murray Cove Sub.	LJP
5	5-27-94	River Cove Sub.	LJP
6	6-1-94	Annex. to Murray City 94-5-135	LJP
7	6-1-94	Alexander Ridge Sub.	LJP
8	6-30-94	Annex. to Murray City 94-6-162	LJP
9	6-30-94	Worthington Est. Sub.	LJP
10	1-23-95	Amended Beals Sub.	LJP
11	2-13-95	Rubber Sheeted	SW
12	7-7-95	Ingram Sub. Amended	LJP
13	9-28-95	Tim & Sherry Wyatt	ALM
14	11-23-95	Change S.L. County Surveyor, Vaughn E. Butler	ALM
15	11-23-95	Standardize Layer Colors	ALM
16	11-24-95	Old Form of Murray Sub.	ALM
17	1-11-96	Jones Place	ALM
18	7-15-96	River Cove No. 2	BJR
19	11-3-97	Jordan Crest Estates	PSB
20	5-26-99	Ervin Burkhardt Lot Split	PSB
21	7-30-99	Glencoe Townhomes Phase 1	PSB
22	9-7-99	Glencoe Townhomes Phase 1 Amended	PSB
23	4-17-00	Glencoe Townhomes Phase 2	PSB
24	8-27-03	Lazy Acres Subdivision	PSB
25	8-27-03	Maplewood Estates	PSB
26	11-19-07	Change S.L. County Surveyor, Reid J. Demman	MSK

SEC. 14
T2S-R1W

AREA REFERENCE PLAT

PREPARED BY THE OFFICE OF
THE SALT LAKE COUNTY SURVEYOR

REID J. DEMMAN
SALT LAKE COUNTY SURVEYOR

Date Converted - 07/23/92

SALT LAKE COUNTY
GEOGRAPHIC INFORMATION SYSTEM
©1992

NOTICE
THE VALUES SHOWN HEREON REFERENCE THIS PLAT ONLY. ADJACENT AREA REFERENCE PLATS MAY SHOW DIFFERENT VALUES FOR IDENTICAL LINES. A.R.P. VALUES HAVE BEEN GATHERED OVER A NUMBER OF YEARS, USING A VARIETY OF EQUIPMENT WITH VARYING DEGREES OF ACCURACY. ALL INFORMATION SHOWN IS FOR REFERENCE ONLY AND SHOULD BE FIELD VERIFIED. COPIES OF FIELD TRAVERSES ARE AVAILABLE FOR MOST SECTIONS. STATE PLANE COORDINATES ARE ALSO AVAILABLE FOR SOME SECTIONS. PLEASE CHECK WITH STAFF.

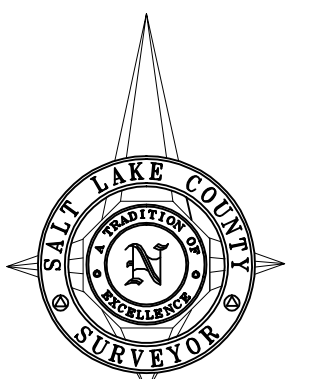

SCALE 1" = 300'