

- ★ -Tie Sheet Is Available
- Δ -Designates S.L. County Surveyor's File No.
- -Designates S.L. County Recorder's File No.

REVISIONS			
NO.	DATE	DESCRIPTION OF REVISION	INITIAL
1	9-20-93	Update 1993 Subdivisions	LJP
2	11-22-94	Draper Industrial Park	LJP
3	2-10-95	Rubber Sheeted	SW
4	6-28-96	Changed S.L. Co. Surveyor - Vaughn E. Butler	P.J.L.
5	6-28-96	Galena Hills Subdivision Phase 1	P.J.L.
6	6-28-96	Galena Hills Subdivision Phase 1	P.J.L.
7	6-28-96	Galena Hills Phase II Subdivision	P.J.L.
8	5-14-99	Brickerhaven Subdivision Phase 1	PSB
9	5-16-01	Allegro @ Corner Canyon Subdivision	PSB
10	6-12-01	Andante Subdivision Amended	PSB
11	6-18-01	Allegro @ Corner Canyon Street Dedication	PSB
12	7-11-01	Brickerhaven Subdivision Phase 3	PSB
13	7-10-02	Brickerhaven Subdivision Phase 2	PSB
14	10-3-02	TK Acres	PSB
15	2-11-03	add WC to NW SEC COR	EGB
16	9-22-04	Greenfield Farms Phase 2 Amended	PSB
17	10-25-05	TK Acres Amended	PSB
18	8-11-08	Changed S.L. Co. Surveyor - Reid J. Demman	MSK

SEC. 36 T3S-R1W AREA REFERENCE PLAT

PREPARED BY THE OFFICE OF
THE SALT LAKE COUNTY SURVEYOR

COMPILED BY
REID J. DEMMAN
SALT LAKE COUNTY SURVEYOR

NOTICE

THE VALUES SHOWN HEREON REFERENCE THIS PLAT ONLY. ADJACENT AREA REFERENCE PLATS MAY SHOW DIFFERENT VALUES FOR IDENTICAL LINES. A.R.P. VALUES HAVE BEEN GATHERED OVER A NUMBER OF YEARS, USING A VARIETY OF EQUIPMENT WITH VARYING DEGREES OF ACCURACY. ALL INFORMATION SHOWN IS FOR REFERENCE ONLY AND SHOULD BE FIELD VERIFIED. COPIES OF FIELD TRAVERSES ARE AVAILABLE FOR MOST SECTIONS. STATE PLANE COORDINATES ARE ALSO AVAILABLE FOR SOME SECTIONS. PLEASE CHECK WITH STAFF.

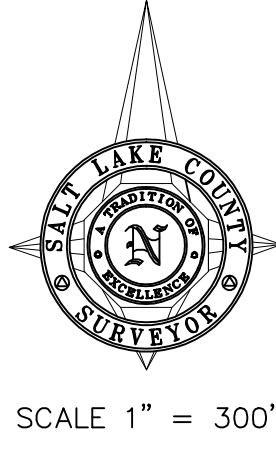

SCALE 1" = 300'

Date Converted - 08/21/92
Date Reviewed - 02/11/2003