

- ★ - Tie Sheet Is Available
- △ - Designates S.L. County Surveyor's File No.
- - Designates S.L. County Recorder's File No.

NOTICE

THE VALUES SHOWN HEREON REFERENCE THIS PLAT ONLY. ADJACENT AREA REFERENCE PLATS MAY SHOW DIFFERENT VALUES FOR IDENTICAL LINES. A.R.P. VALUES HAVE BEEN GATHERED OVER A NUMBER OF YEARS, USING A VARIETY OF EQUIPMENT WITH VARYING DEGREES OF ACCURACY. ALL INFORMATION SHOWN IS FOR REFERENCE ONLY AND SHOULD BE FIELD VERIFIED. COPIES OF FIELD TRAVERSES ARE AVAILABLE FOR MOST SECTIONS. STATE PLANE COORDINATES ARE ALSO AVAILABLE FOR SOME SECTIONS. PLEASE CHECK WITH STAFF.

REVISIONS			
NO.	DATE	DESCRIPTION OF REVISION	INITIAL
1	9-24-93	Update 1992 Subs & Road Dedications	LJP
2	12-7-93	Densley Est. No. 3	LJP
3	2-1-94	Marblewood 3 & 4 Sub.	LJP
4	3-20-95	Rubber Sheeted	SW
5	9-29-95	Add Notice	ALM
6	9-29-95	Heaton Meadows	ALM
7	11-30-95	Change S.L. County Surveyor, Vaughn E. Butler	ALM
8	12-1-95	Beeton Subdivision	ALM
9	2-08-96	Bethany Hills	ALM
10	6-21-96	Kidd Acres	PJL
11	12-13-96	Clark/Anderson Subdivision	BJB
12	9-15-97	Heaton Meadows Phase 2	PSB
13	6-16-98	Watson Minor Subdivision	MDS
14	01-04-99	Silcox Meadows Subdivision	PSB
15	01-13-99	Marblewood Phase 3 Am'd	PSB
16	11-3-00	Drury Subdivision	PSB
17	2-21-01	Oliver Meadows Subdivision	PSB
18	4-29-02	Pepper's Meadow Subdivision	PSB
19	4-30-02	Marketview Drive Street Dedication	PSB
20	5-20-02	Residences at the Bluffs	PSB
21	11-19-02	Cannon Ridge Estates	PSB
22	4-10-03	Vintage on the Bluffs #1	PSB
23	4-10-03	Vintage on the Bluffs #2	PSB
24	6-16-03	Vintage on the Bluffs #3-#8	PSB
25	6-16-03	Vintage on the Bluffs #12	PSB
26	6-16-03	Vintage on the Bluffs #15	PSB
27	9-9-03	Vintage on the Bluffs #10-11	PSB
28	9-9-03	Vintage on the Bluffs #13-14	PSB
29	1-14-04	Vintage on the Bluffs #16-25	PSB
30	4-28-05	Hunter's View Subdivision	PSB
31	12-14-05	Bradbury Meadows Subdivision	PSB
32	8-11-08	Change S.L. County Surveyor, Reid J. Demman	MSK

SEC. 03 T4S-R1W AREA REFERENCE PLAT

PREPARED BY THE OFFICE OF
THE SALT LAKE COUNTY SURVEYOR

COMPILED BY

REID J. DEMMAN

SALT LAKE COUNTY SURVEYOR

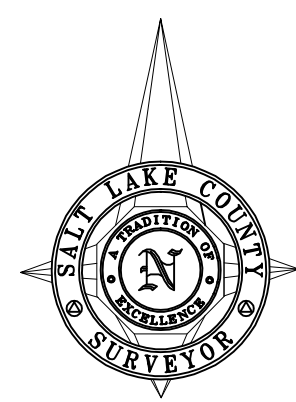

SCALE 1" = 300'

Date Converted - 09/03/92

SALT LAKE COUNTY
GEOGRAPHIC INFORMATION SYSTEM
©1992

03-T4S-R1W

03-T4S-R1W